

# CATALOG

ROBOTIC FUME EXTRACTION



# SMIG







**EDR** torches<sup>®</sup>  
Evolution Design Robotics



# We are present worldwide

## Fume extraction a SMIG

The ASMIG system guarantees the maximum extraction of welding fumes in BOT systems, being this system modular and can be incorporated as an accessory in an already operating installation.

-  Vacuum Regulation System External To The Pump. Independent Adjustment Of Each Torch In Centralized Systems
-  Independent elbow. allow the systems to be adapted to different types of standard necks of the bot series
-  Large Diameter Pipe With Lower Suction Losses
-  Different sizes and lengths of suction nozzles. adjust



“We understand that the development of a product starts at the design stage but just as important are quality and production”

Companies with technological or industrial character know the importance of innovating to continue in the current market. In EDR torches this becomes a work philosophy, we understand that without innovation it is not possible to advance in such a competitive world where companies and professionals need increasingly complex solutions.

EDR torches has a strong R & D department dedicated to the development of new welding applications, providing customized solutions both in the area of robotic welding and manual.

We understand that the development of a product begins at the design stage but just as important are the quality and production designed and tested.

The long experience of EDR torches in all sectors related to welding makes us capable of providing the best solutions to your manufacturing challenges, tell us what you need and we will make it possible.

Variety of configurations without losing programming.

Extraction systems for collaborative and industrial robots, ASMIG is a modular system that adapts to the torch that you currently have installed without the need for change or reprogramming in BOT series systems



# Fume extraction



Incorporate your aSMIG system to your installed BOT or BASIC series torch, and reduce gas emissions without changing the programming.



## INDEPENDENT MODULAR

Independent tube system eliminates torch tube contamination and increases suction performance.



Efficiency of suction systems according to welding position.

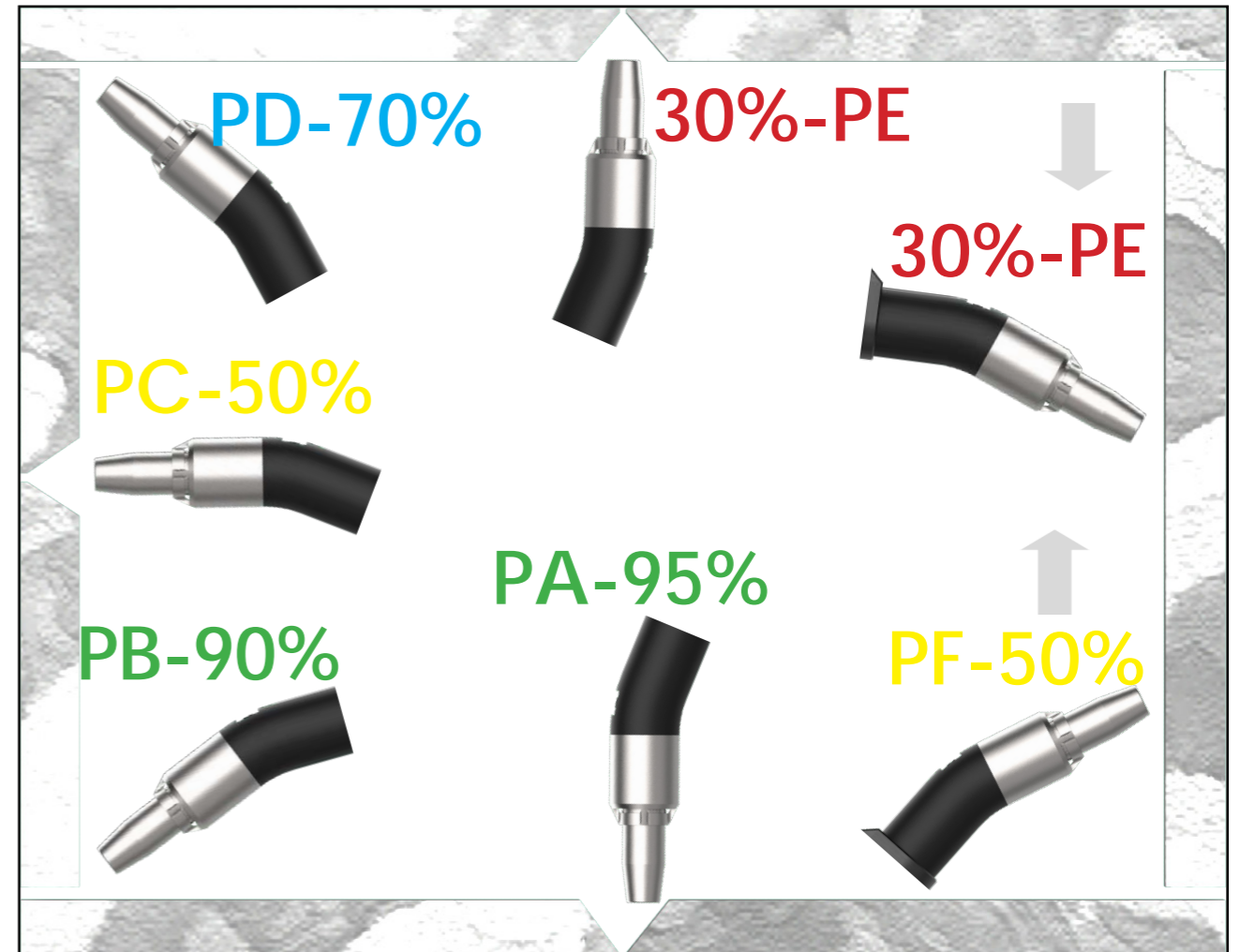

ASMIG FOR BASIC TORCHES

ASMIG FOR BOT TORCHES



AS

1

3

4

GAS COOLING

BASIC-42G 300A

- BE3G22 R98 1300 22 Welding torch 42G-22° gas 3mts-Euro type
- BE4G22 R98 1400 22 Welding torch 42G-22° gas 4mts-Euro type
- BM3G22 R98 2300 22 Welding torch 42G-22° gas 3mts-Miller type
- BM4G22 R98 2400 22 Welding torch 42G-22° gas 4mts-Miller type
- BP3G22 R98 3300 22 Welding torch 42G-22° gas 3mts-Panasonic type
- BP4G22 R98 3400 22 Welding torch 42G-22° gas 4mts-Panasonic type

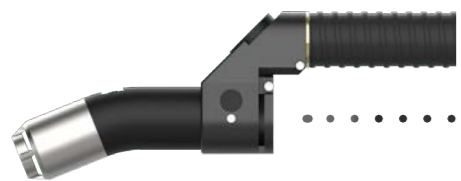

AS R30 8222 ASMIG BOT-40W 22°F -BASIC

LIQUID COOLING

BASIC-52W 500A

- BE3W22 R99 1300 22 Welding torch 52W-22° gas 3mts-Euro type
- BE4W22 R99 1400 22 Welding torch 52W-22° gas 4mts-Euro type



67 R41.1023 Bracket 67°



5040 R75.0020 D50x4

Long máx 2.5 mts  
dia. 32 mm

Dia. 38-50 mm

Not included in torch

AS + 1 + 3 + 4

Sample installation code: AS-BE3W22-67-5040





# BOT

**LIQUID COOLING**  
ASMIG - BOT-40W 500A

**e-BOT**



|    |          |           |
|----|----------|-----------|
| T1 | R10.0011 | L76xD15.5 |
| T2 | R10.0012 | L76xD13   |
| T3 | R10.0211 | L79xD15.5 |

|        |          |                    |   |          |              |
|--------|----------|--------------------|---|----------|--------------|
| AS4022 | R30 8022 | ASMIG BOT-40W 22°  | + | R14.0220 | BOT-40W-22°  |
| AS402F | R30 8222 | ASMIG BOT-40W 22°F | + | R14.0222 | BOT-40W-22°F |
| AS402L | R30 8122 | ASMIG BOT-40W 22°L | + | R14.0221 | BOT-40W-22°L |
| AS4045 | R30 8045 | ASMIG BOT-40W 45°  | + | R14.0450 | BOT-40W-45°  |



**BICOMP**

|     |             |         |
|-----|-------------|---------|
| P10 | R10.0400.10 | M10 1.0 |
| P12 | R10.0400.12 | M10 1.2 |
| P16 | R10.0400.16 | M10 1.6 |



|        |          |                              |
|--------|----------|------------------------------|
| EEXXXL | R92.1XXX | power cable liquid Euro      |
| EMXXXL | R92.2XXX | power cable liquid Miller    |
| EPXXXL | R92.3XXX | power cable liquid Panasonic |
| EOXXXL | R92.4XXX | power cable liquid OTC       |

3.1

**INDUSTRIAL**

|      |          |               |
|------|----------|---------------|
| EB   | R53.0001 | anticollision |
| 4040 | R73.0010 | D40x4         |
| 5040 | R73.0020 | D50x4         |

**COBOTS**

|      |          |             |
|------|----------|-------------|
| 67   | R41.1023 | Bracket 67° |
| 5140 | R75.0020 | D50x4       |



|    |          |               |
|----|----------|---------------|
| K1 | R04.0000 | Neck tool BOT |
|----|----------|---------------|

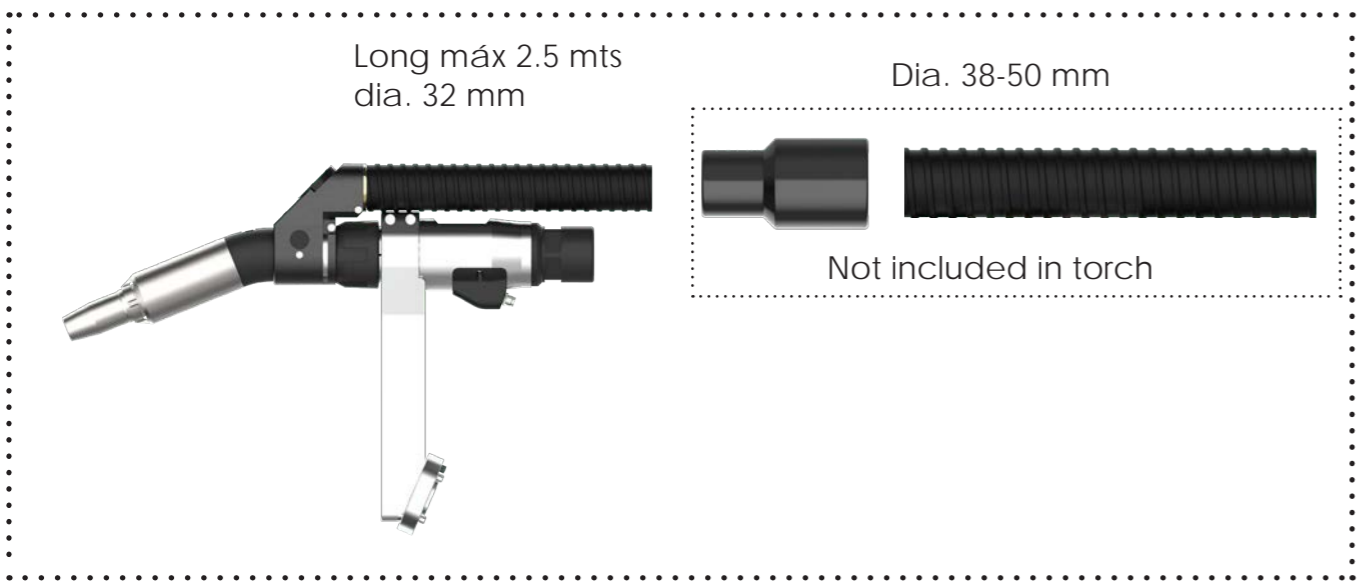

Sample installation code: T1-P12-AS4022-EE1300L-67-5140-K1



# Fume extraction ASMIG



ASMIG is a welding fume extraction system for robotic torches of the BASIC or BOT range, it is an external system that can be incorporated to any already installed torch of the BASIC or BOT line, both in industrial ROBOTS and COBOTS.

The system can also be supplied with the torches already incorporated.

Several configurations of standard necks are available but can be ordered for other models of the BOT line upon request.

## ASMIG for BASIC

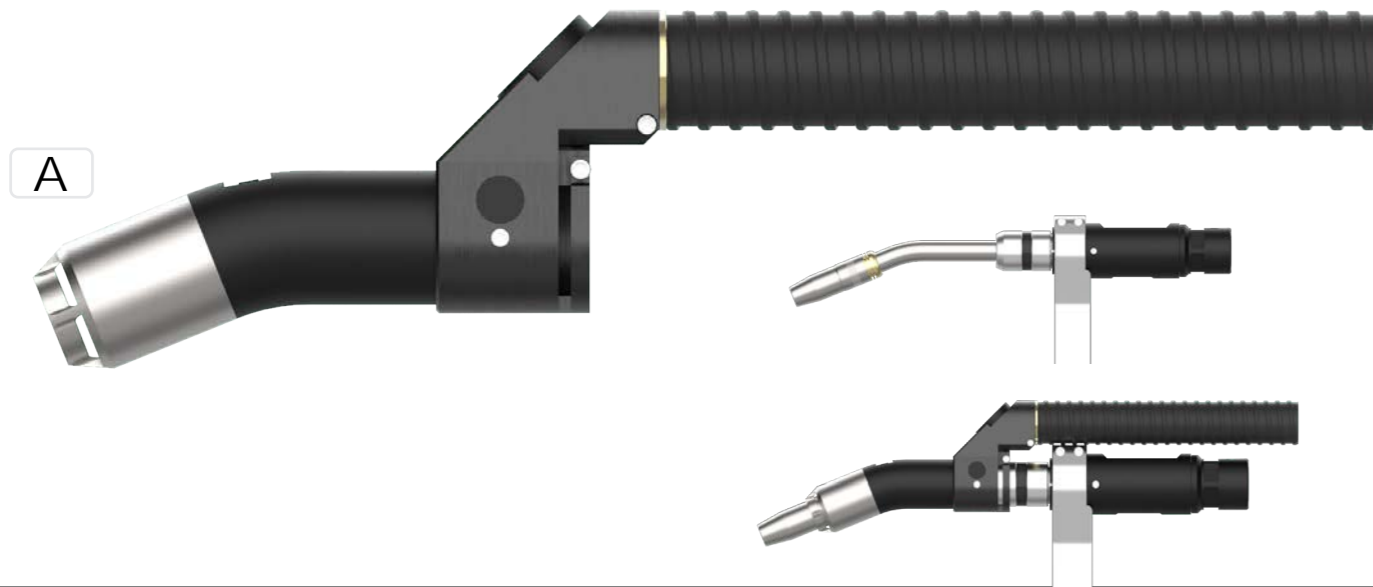

| Pos. | CODE     | TYPE                             | Min. Q. |
|------|----------|----------------------------------|---------|
| A    | R30 8222 | ASMIG SYSTEM for Torch BASIC 22° | 1       |

## Torch compatible with ASMIG BASIC

| Pos. | CODE        | TYPE   | Min. Q. |
|------|-------------|--|---------|
| A.1  | R98 1XXX 22 | Welding torch 42G-22° gas BASIC XXmts-Euro type      | 1       |
| A.2  | R98 2XXX 22 | Welding torch 42G-22° gas BASIC XXmts-Miller type    | 1       |
| A.3  | R98 3XXX 22 | Welding torch 42G-22° gas BASIC XXmts-Panasonic type | 1       |
| A.4  | R99 1XXX 22 | Welding torch 52W-22° gas eBASIC 4mts-Euro type      | 1       |

## ASMIG for BOT

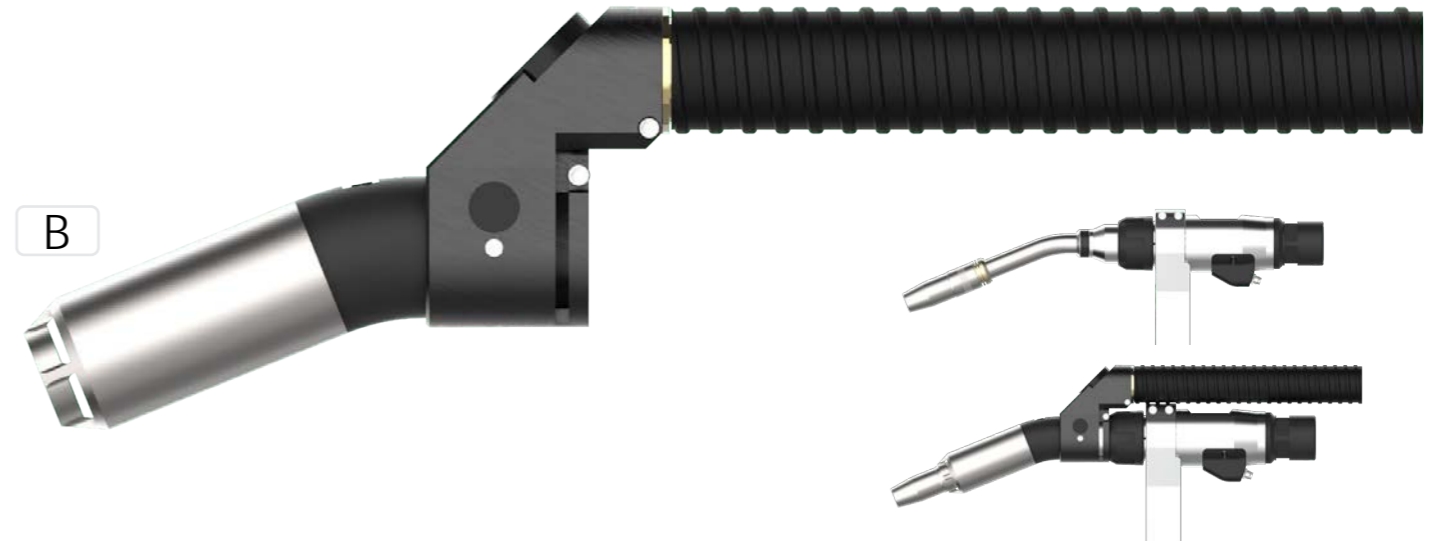

| Pos. | CODE     | TYPE                                     | Min. Q. |
|------|----------|--|---------|
| B    | R30 8022 | ASMIG SYSTEM for Torch neck BOT-40W 22°  | 1       |
|      | R30 8122 | ASMIG SYSTEM for Torch neck BOT-40W 22°L | 1       |
|      | R30 8045 | ASMIG SYSTEM for Torch neck BOT-40W 45°  | 1       |

B.1 BOT-40W 22° N

B.2 BOT-40W 22°L L

B.3 BOT-40W 45° N



## Necks compatible with ASMIG BOT

| Pos. | CODE     | TYPE  | Min. Q. |
|------|----------|---|---------|
| B.1  | R14 0220 | Torch neck BOT-40W 22° (X=64 mm, Z=247 mm)-long type N  | 1       |
| B.2  | R14 0221 | Torch neck BOT-40W 22°L (X=64 mm, Z=297 mm)-long type L | 1       |
| B.3  | R14 0450 | Torch neck BOT-40W 45° (X=111 mm, Z=217 mm)-long type N | 1       |



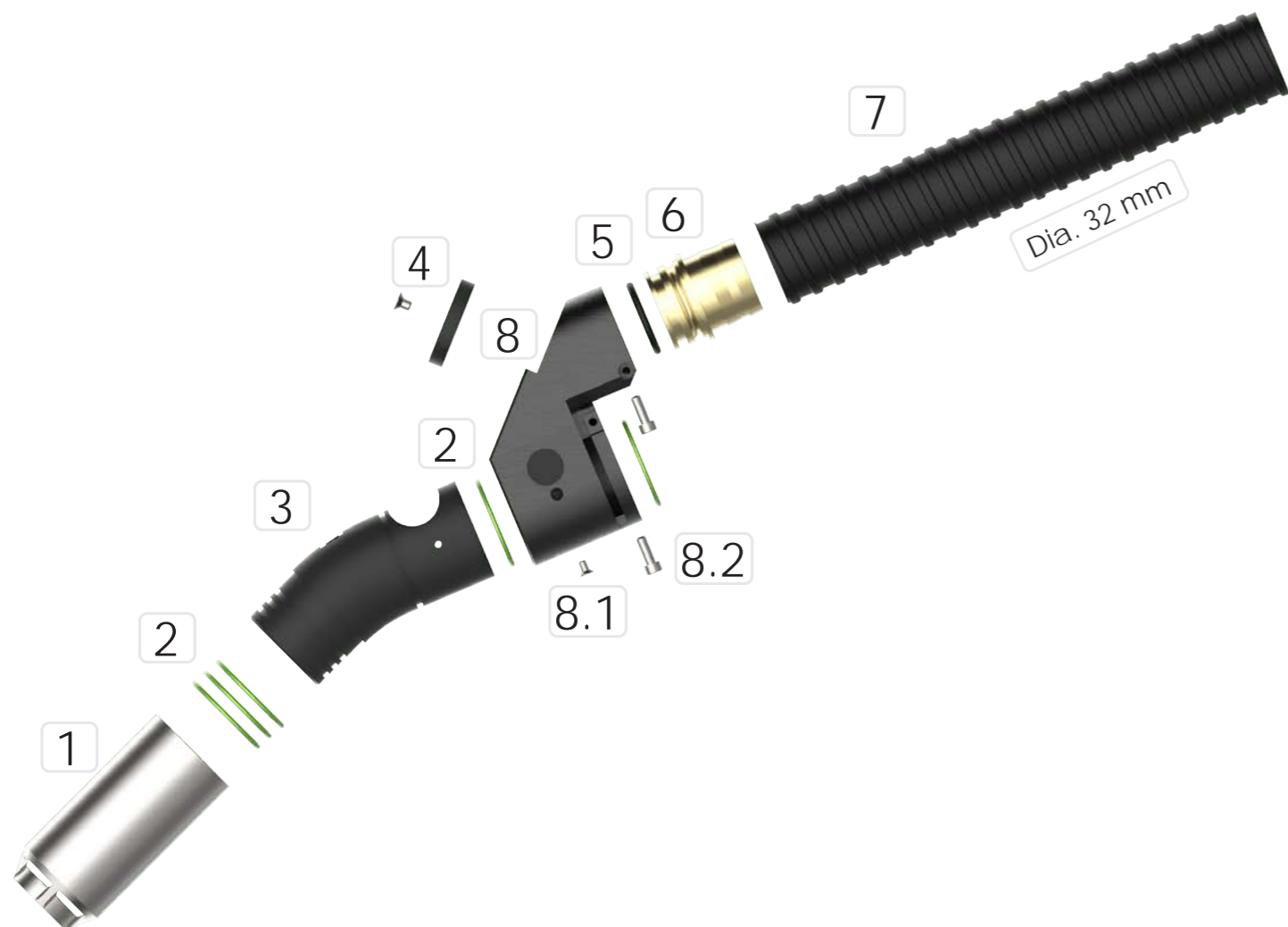

| Pos. | CODE         | TYPE                          | Min. Q. |
|------|--------------|-------------------------------|---------|
| 1    | R30 8090     | Nozzle ASMIG L90xØ42.5 mm     | 1       |
|      | R30 8055     | Nozzle ASMIG L55xØ42.5 mm     | 1       |
| 2    | R30 8005     | O-ring ASMIG Ø37 mm           | 10      |
| 3    | R3 8022 01   | Support tuber ASMIG 22G       | 1       |
|      | R3 8022 02   | Support tuber ASMIG 22GL      | 1       |
|      | R3 8045 01   | Support tuber ASMIG 45G       | 1       |
|      | R3 8122 02   | Support tuber ASMIG BASIC 22G | 1       |
| 4    | R3 8002 01   | ASMIG regulating cap          | 1       |
| 5    | R6 0203 02   | O-ring seal                   | 4       |
| 6    | R3 8002 04   | Tube fitting ASMIG            | 1       |
| 7    | R30 3032     | ASMIG external tube D32       | 1       |
| 8    | R3 8002      | Support ASMIG                 | 1       |
| 8.1  | R5 1000 20   | Screw M4x12                   | 2       |
| 8.2  | R8 0000 0203 | Screw BOT M4x6                | 2       |

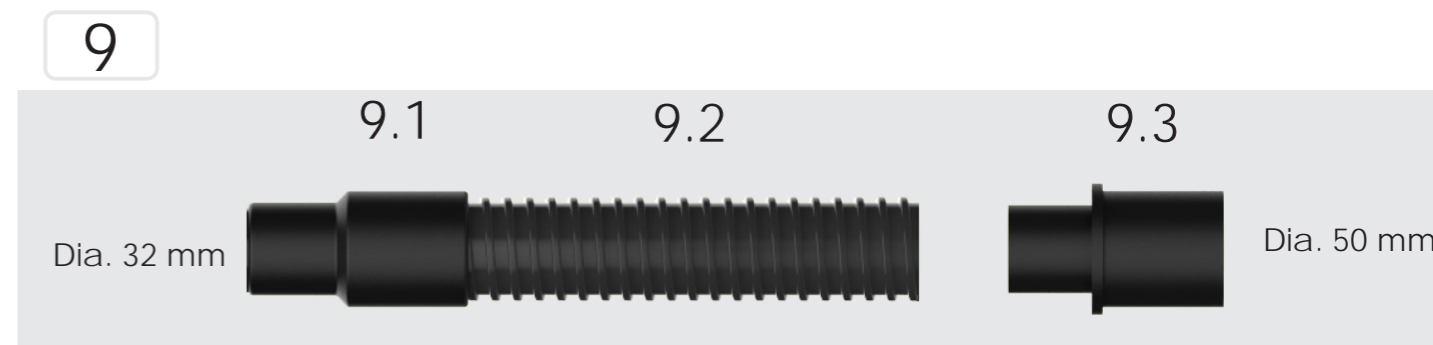

| Pos. | CODE     | TYPE                      | Min. Q. |
|------|----------|---------------------------|---------|
| 9    | R30 800L | Extension set ASMIG 3 mts | 1       |
| 9.1  | R30 3832 | Reducer ASMIG D.38-32 mm  | 1       |
| 9.2  | R30 3038 | ASMIG external tube D38   | 1       |
| 9.3  | R30 3850 | ASMIG terminal D.38-50 mm | 1       |

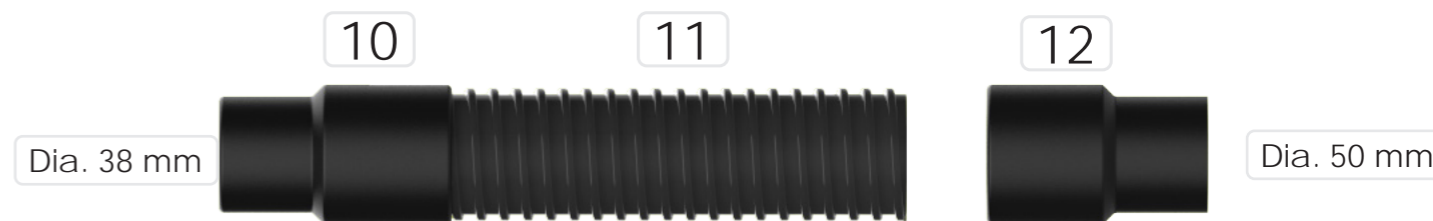

| Pos. | CODE     | TYPE                      | Min. Q. |
|------|----------|---------------------------|---------|
| 10   | R30 5038 | Reducer ASMIG D.50-38 mm  | 1       |
| 11   | R30 3050 | ASMIG external tube D50   | 1       |
| 12   | R30 5050 | ASMIG terminal D.50-50 mm | 1       |

### ASMIG system configuration.



### ASMIG for BOT 40W22G Ref.R30 8022

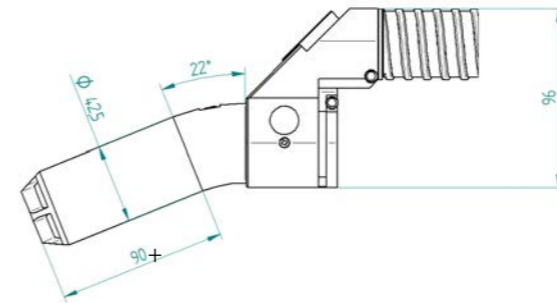

### ASMIG BASIC 42/52 22F Ref.R30 8222

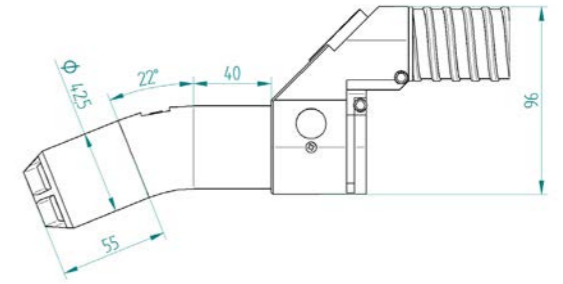

### ASMIG BOT 40W22L Ref.R30 8122

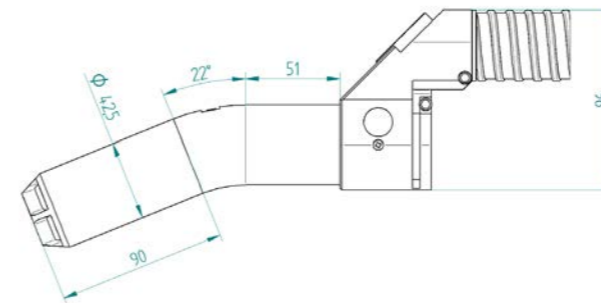

### ASMIG BOT 40W45G Ref.R30 8045

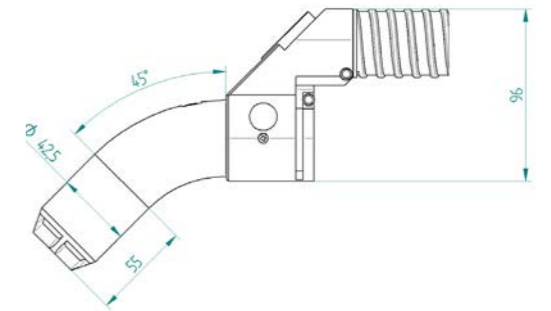

### ASMIG system

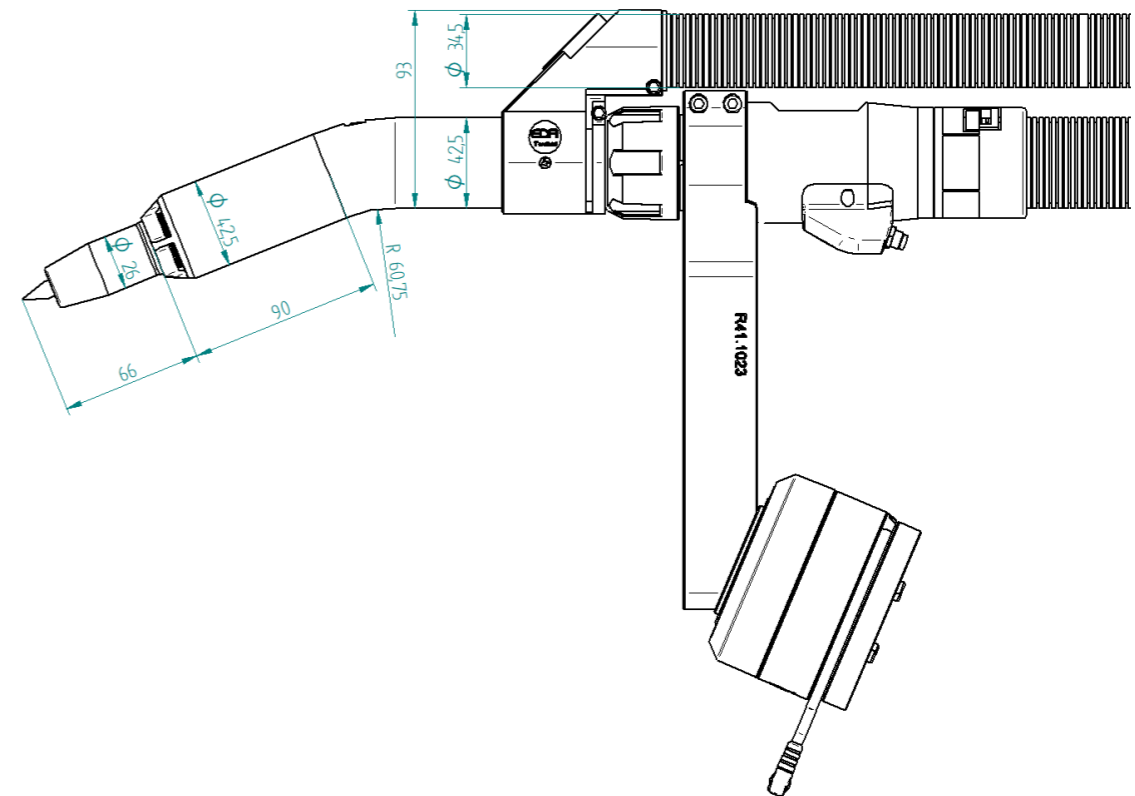



# VAC2-PRO

CE HIGH VACUUM SUCTION

- High Vacuum**  
Extraction System
- MIG-MAG Welding 180/260m3/h**  
On-torch Extraction Unit
- Jet-Pulse**  
Automatic Filter Cleaning
- Mobile Unit**  
Lockable wheels



### Usage Areas

High Vacuum On Torch Welding Fume Extraction System for Manuel Mig/Mag Welding Torches  
 Suitable for filtering unalloyed, low alloy and high alloy steel  
 Provides high performance on Corner Welding  
 Provides high performance on T Joint Welding  
 Provides high performance on Overlay Welding, techniques  
 Not recommended for butt-welding

### Specifications

On Torch Welding Fume Extraction unit has been designed to Non-stop operations  
 With its automatic-cleaning filter system, filters are cleaned automatically  
 Collects dust and particles in the dust bucket  
 Reliable protection with its high efficient cartridge filters  
 45mm hose connection for global torches

| Pos. | CODE     | TYPE                          | Min. Q. |
|------|----------|-------------------------------|---------|
| 1    | R30 9022 | Vacuum module VAC2-PRO 2.2kw. | 1       |



| Pos. | CODE     | TYPE  | Min. Q. |
|------|----------|---|---------|
| A    | R30 0251 | 235x235x48 FILTERING CELL                         |         |
| B    | R30 0267 | D220 H200 HYDRO-OLEOPHOBIC CARTRIDGE FILTER CAT M |         |
| C    | R30 0013 | D330 H98 ABSOLUTE FILTER                          |         |
| D    | R30 0140 | 10x22 ADHESIVE GASKET                             |         |

Attention!  
 These filters must be checked every six months. In case they are worn it will be necessary to replace them with new ones, to be requested as a spare parts to EDR.  
 Will accept no responsibility in case of use of NON-ORIGINAL filters



- 1. Chassis Cable Holder
- 2. Carrying Handle
- 3. On/Off, Auto/Manual Switch
- 4. Main Fan Section
- 5. Release Fastening
- 6. Optional Filter Section (HEPA or Activated Carbon)
- 7. DUSTOP Manual Filter Cleaner
- 8. Cartridge Filter Section
- 9. Pre-Filter and Dust Collector
- 10. Fume Inlet
- 11. Lockable Castors

| MODEL                    | TYPE        |
|--------------------------|-------------|
| Power (kW)               | 1.1         |
| Voltage (V)              | 230         |
| Frequency (Hz)           | 50/60       |
| Max Vacuum Rate (mm H2O) | 2500        |
| Max AirFlow Rate (m3/h)  | 360         |
| Noise Level (dB (A)) *   | 76          |
| Filter Type              | Cartridge M |
| Filter Surface (cm3)     | 7500        |
| Capacity (lt)            | 13          |
| Suction Inlet (Ø)        | 50          |
| Dimensions (cm)          | 40X50X86    |

# Fume extration for robot torches



EDRtorches, S.L.  
Calle Miguel Angel Blanco 28, 46138  
Rafelbuñol - Valencia Spain.  
[www.edrtorches.com](http://www.edrtorches.com)  
[info@edrtorches.com](mailto:info@edrtorches.com)  
Tel. 0034 963 558 893

